

PANORAMA HOTEL

PRAGUE

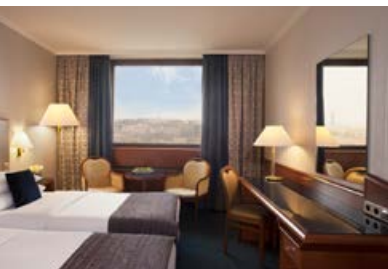

EVENTS AT PANORAMA



PANORAMA HOTEL

PRAGUE

BASIC INFORMATION



FREE WI-FI

We provide high-speed wi-fi in all meeting rooms, relaxation spaces, guest rooms and public places.



EFFECTIVE COMMUNICATION

24-hour support from our team. Every meeting room has a telephone with pre-set important telephone numbers for your needs.



PERSONAL SUPPORT

For every event you will have a specialised, highly qualified team of people available to you.



FAST ANSWERS TO QUESTIONS

We will confirm every e-mail within three hours and prepare a proposal within 24 hours. We do not leave anything to chance and carefully go through plans to make sure everything is arranged and taken care of. You will have access to the meeting rooms at least one hour in advance, or earlier if needed (depending on availability).



PANORAMA HOTEL

PRAGUE

HALF-DAY BASIC PACKAGE

FOR A PERIOD OF UP TO 6 HOURS

Lease of main meeting room

- One mineral water per person in the meeting room
- Flip chart, projection screen, data projector
- Pens, notepads and menthol sweets for every attendee

Business lunch

- Including one soft drink
- Three-course menu of the day or buffet in accordance with the chef's choice

In Addition

- Morning coffee break

Assistant

- Panorama assistant available

Extra coffee throughout the day € 3 per person



€ 48

per person



CONDITIONS

- VAT is included in the price (VAT is subject to change)
- A service fee of 5% of the total amount will be credited to your account
- Buffet lunch is subject to minimum 15 persons
- Suitable space for meetings is located in accordance with the number of attendees and the required arrangement

Do not hesitate to contact us:

+420 261 191 393 | events@panoramahotelprague.com

PANORAMA HOTEL

PRAGUE

ALL-DAY BASIC PACKAGE

Rental of main meeting room

- Two mineral water battles per person in the meeting room
- Flip chart, projection screen, data projector
- Pens, notepads and menthol sweets for every attendee

Lunch

- Including soft drink
- Three-course menu of the day or buffet in accordance with the chef's choice

In Addition

- Morning and afternoon coffee breaks

Assistant

- Panorama assistant available

Extra coffee throughout the day € 5 per person



€ 59
per person



CONDITIONS

- VAT is included in the price (VAT is subject to change)
- A service fee of 5% of the total amount will be credited to your account
- Buffet lunch is subject to minimum 15 persons
- Suitable space for meetings is located in accordance with the number of attendees and the required arrangement

PANORAMA HOTEL

PRAGUE

HALF-DAY PREMIUM PACKAGE

FOR A PERIOD OF UP TO 6 HOURS

Lease of main meeting room

- One mineral water bottle per person in the meeting room
- Flip chart, projection screen, data projector
- Pens, notepads and menthol sweets for every attendee

Business lunch

- Including one soft drink
- Three-course menu of the day or buffet in accordance with the chef's choice*

In Addition

- One soft drink per person
- Morning coffee break

Assistant

- Panorama assistant available



€ 59

per person



CONDITIONS

- VAT is included in the price (VAT is subject to change)
- A service fee of 5% of the total amount will be credited to your account
- Buffet lunch is subject to minimum 15 persons
- Suitable space for meetings is located in accordance with the number of attendees and the required arrangement

*Buffet:

- Soup of the day
- Salads
- Main course
- Option of vegetarian main course
- Selection of desserts

PANORAMA HOTEL

PRAGUE

ALL-DAY PREMIUM PACKAGE

Rental of main meeting room

- Two mineral water bottles per person in the meeting room
- Flip chart, projection screen, data projector
- Pens, notepads and menthol sweets for every attendee

Lunch

(including soft drink)

- Three-course menu of the day or buffet in accordance with the chef's choice*

In Addition

- Two soft drinks per person
- Morning and afternoon coffee breaks
- Coffee throughout the day

Assistant

- Panorama assistant available



€ 74
per person



CONDITIONS

- VAT is included in the price (VAT is subject to change)
- A service fee of 5% of the total amount will be credited to your account
- Buffet lunch is subject to minimum 15 persons
- Suitable space for meetings is located in accordance with the number of attendees and the required arrangement

*Buffet:

- Soup of the day
- Salads
- Main course
- Option of vegetarian main course
- Selection of desserts

PANORAMA HOTEL

PRAGUE

CONFIGURATION AND CAPACITY

		Theatre	School	Board	U-shape	Banquet	Reception	Cabaret	Hollow square	Dimensions W x L x H (metres)	Area in sqm	Columns	Daylight
Ground floor	SALON 1	42	30	28	22	24	50	18	24	10,5 x 5,9 x 3,1	61	✗	✗
	SALON 2	20	14	12	14	8	25	6	16	5,4 x 5,6 x 3,1	30	✗	✗
	SALON 3	20	14	12	14	8	25	6	16	5,3 x 5,9 x 3,1	31	✗	✗
	SALON 4	80	60	30	36	48	100	36	42	16,5 x 6,8 x 3,1	112	✗	✓
	SALON 1+2	62	44	36	34	32	65	24	40	15,9 x 5,9 x 3,1	94	✗	✗
	SALON 2+3	40	28	20	28	16	30	12	32	10,7 x 5,8 x 3,1	62	✗	✗
	SALON 1+2+3	82	58	52	50	48	110	36	54	21,1 x 5,9 x 3,1	124	✗	✗
First floor	VIENNA	120	110	35	30	80	120	60	36	15 x 12,5 x 3,1	187	✓	✓
	VALETTA	120	64	36	26	56	100	42	36	13 x 11,5 x 3,1	150	✓	✓
	PANORAMA	30	20	16	18	16	30	12	18	4,6 x 15,9 x 3,1	73	✗	✓
	RESTAURANT BOHEMIA	Capacity of up to 300 seats (option of splitting, private dining)											

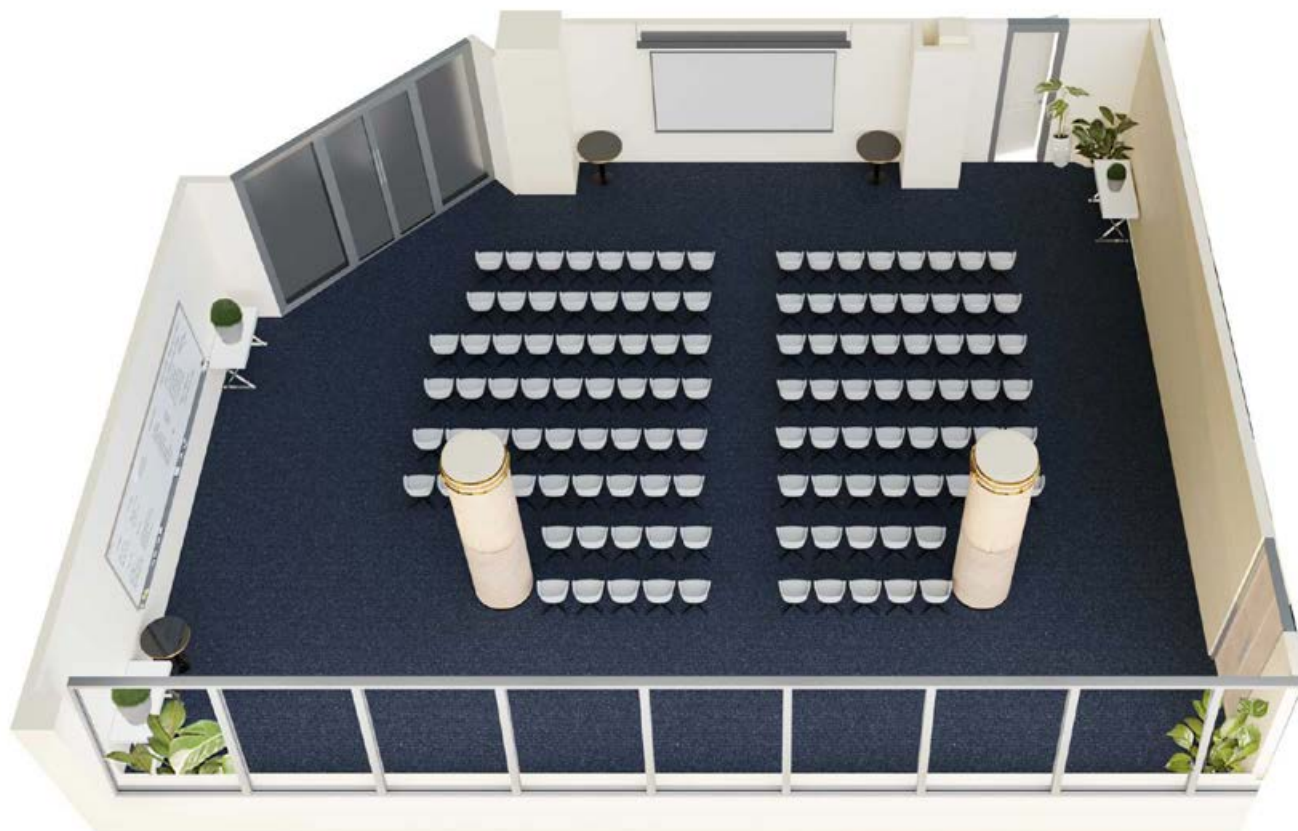

Vienna, set-up theatre

PANORAMA HOTEL PRAGUE

GROUND FLOOR

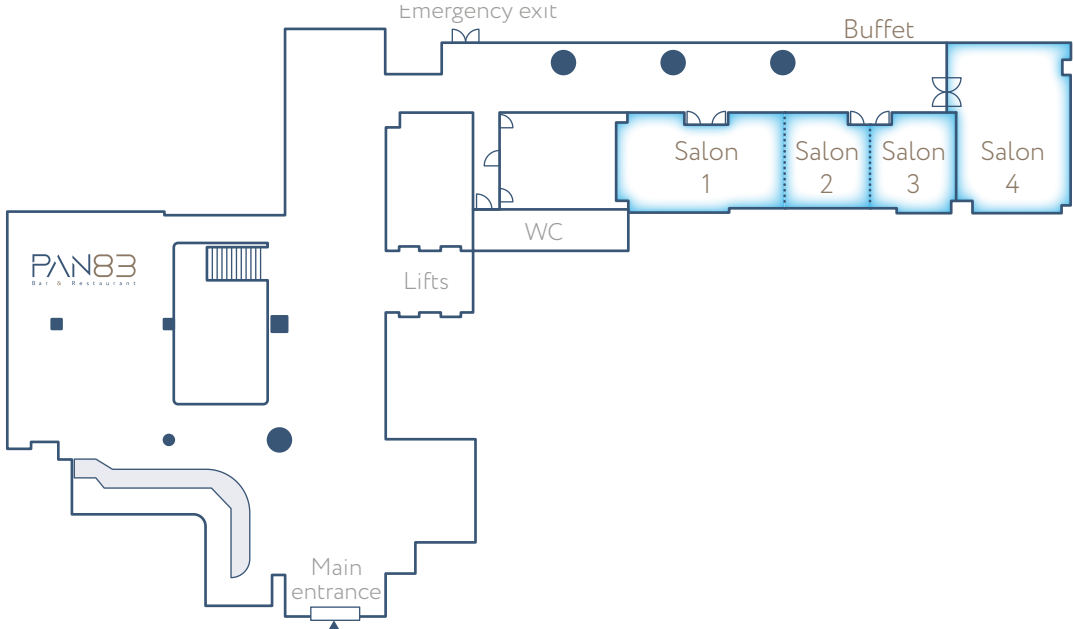

FIRST FLOOR

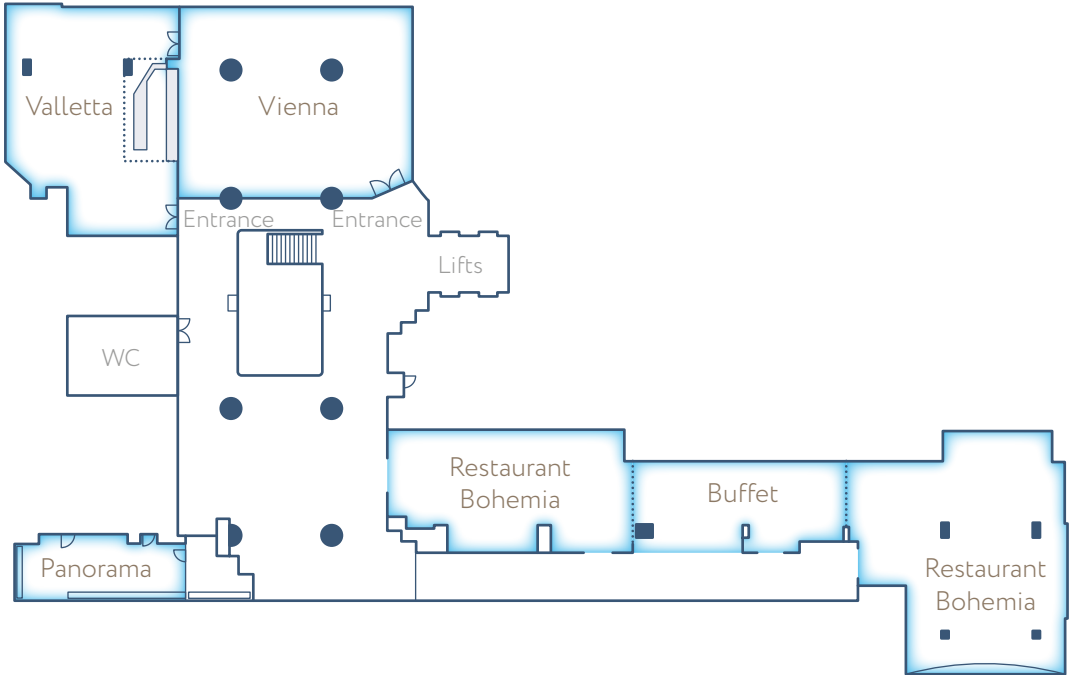

PANORAMA HOTEL

PRAGUE

COFFEE BREAKS

“Welcome” coffee break

- Freshly ground coffee
- Selection of teas, jugs of water



€ 6
per person

“Basic” coffee break

- Freshly ground coffee
- Selection of teas, jugs of water, sweet pastries



€ 10
per person

Coffee throughout the meeting

€ 5 per person /all day

€ 3 per person /half day

“Panorama” coffee break

- Coffee throughout the meeting
- Freshly ground coffee, decaffeinated coffee, selection of teas, juices, soft drinks sweet (2 pcs) and salty snack (2 pcs), fresh fruit



€ 16
per person



CONDITIONS

- VAT is included in the price (VAT is subject to change)
- A service fee of 5% of the total amount will be credited to your account

PANORAMA HOTEL

PRAGUE

SNACK BUFFET MENU

Starters

- Salad bar and dressings
- Assortment of cold sandwiches (3 pcs per person)
- Assortment of hot starters (3 pcs per person)

Desserts

- Mini sweets (3 pcs per person)
- Fresh fruit



€ 18

per person, including water



CONDITIONS

- VAT is included in the price (VAT is subject to change)
- A service fee of 5% of the total amount will be credited to your account

PANORAMA HOTEL

PRAGUE

CHEF'S BUFFET

Starters

- Cold starters and salamis
- Salads and dressings

Soups

- Soup of the day

Main courses

- Three main courses
(including one vegetarian option)

Sides

- Seasonal vegetables
- Rice, potatoes, Etc.

Desserts

- Mini sweets
- Fresh fruit
- Local cheeses

On request

Are you interested in special types of cuisine? Czech, Indian, Asian, halal or kosher? A gala lunch or evening meal? Our Executive Chef Vladimír Kovaříč will prepare an offer in accordance with your requirements.



€ 25

per person, including water

Upgrade to Premium Buffet additional

€ 7 per person



CONDITIONS

- VAT is included in the price (VAT is subject to change)
- A service fee of 5% of the total amount will be credited to your account
- Minimum 15 guests. For less than 15 guests – three-course menu

PANORAMA HOTEL

PRAGUE

SET MENU

Three-course Menu A

- Arugula salad with goat's cheese foam and balsamic
- Grilled chicken, Napolitana spaghetti and fresh basil
- Delicate dark chocolate cake, lemon sorbet

Three-course menu B

- Fine cream of broccoli with butter croutons
- Greek-style chicken leg with olives, baked onions and potatoes
- Panna cotta with raspberry purée

Three-course menu C

- Double beef broth with port wine and chopped vegetables
- Rosemary pork medallions with mushroom risotto and a burgundy sauce
- Cheesecake with blackberry jelly and vanilla ice cream



€ 30

per person

BREAKFAST AND LUNCH PACKAGES

- 2 ham and cheese sandwiches
- 1 pcs seasonal fruit
- 1 pcs sweet pastry
- 1 juice or bottle of mineral water



€ 15

per person

CONDITIONS

- VAT is included in the price (VAT is subject to change)
- A service fee of 5% of the total amount will be credited to your account
- Can be done to takeaway

PANORAMA HOTEL

PRAGUE

EVENING PROGRAM: GALA DINNERS

Four-course Menu A

- Marinated beef carpaccio with arugula and basil pesto
- Chicken broth with chopped vegetables
- Salmon with grilled vegetables and salmon caviar
- Crème brûlée with strawberry sauce and fresh mint

Four-course Menu B

- Tomatoes with mozzarella and basil pesto
- Beef broth with port wine
- Butter fish baked with tomatoes and parmesan, potatoes with chives
- Pistachio cheesecake with a chocolate glaze and crushed pistachios

Four-course Menu C

- Salmon tartare with mixed leaf salad and rye bread
- Cream of broccoli with butter croutons
- Sirloin steak with a pepper sauce and creamy potatoes
- Lemon cake with strawberries and caramel



€ 35

per person



CONDITIONS

- *If you so wish, we can arrange packed lunches. Please order 24 hours in advance*
- *We will be happy to prepare specially assembled packages based on an order*
- *VAT is included in the price (VAT is subject to change)*
- *A service fee of 5% of the total amount will be credited to your account*

PANORAMA HOTEL

PRAGUE

APPETISERS AND COCKTAILS

Cocktail package

Canapes

- 4 pcs € 12 per person
- 6 pcs € 18 per person
- 8 pcs € 24 per person
- Additional canape € 3 per pcs

Choose your canapes from the list:

Cold appetisers/Crostini

- Honey-glazed ham and gherkins
- Emmental and tomatoes
- Honey-glazed ham and cheese
- Smoked salmon and mayonnaise
- Goat's cheese foam and chives
- Grilled seasonal vegetables
- Mozzarella, tomatoes and balsamic
- Marinated herring and iceberg lettuce



€ 3
per 1 pcs



Filled baguettes/Sandwiches

- Brie
- Caviar
- Smoked salmon
- Marinated herring
- Blue cheese and walnuts
- Spicy Hungarian salami and anchovies
- Honey-glazed ham
- Cheese and black olives
- Creamy goat's cheese
- Baby mozzarella and cherry tomatoes
- Spicy Chabai sausage
- Baby prawns



€ 3
per 1 pcs

Skewers

- Mini skewer with Chabai sausage, cucumber and pickled onion
- Mozzarella with sweet chilli sauce wrapped in Parma ham
- Tortilla with smoked salmon and cream cheese
- Tortilla with grilled chicken, romaine lettuce and spicy dressing
- Cantaloupe melon in Parma ham
- Cheese skewer with dark grapes
- Ham roll with cottage cheese and pineapple
- Cherry tomatoes & mozzarella skewer with fresh basil



€ 3
per 1 pcs

CONDITIONS

- VAT is included in the price (VAT is subject to change)
- A service fee of 5% of the total amount will be credited to your account
- Gluten free, vegan and lastose free options available

PANORAMA HOTEL

PRAGUE

WARM APPETISERS

French quiche

- Chicken, leek and cheese
- Grilled bacon, spring onion and cheese
- Ham, red onion and cheese
- Sautéed mushrooms, thyme and cheese
- Grilled seasonal vegetables and cheese



€ 3
per 1 pcs

Main courses

- Mini fried chicken with lemon € 3/pcs
- Mini fried pork with lemon € 3/pcs
- Mini chicken paillard € 3/pcs
- Mini pork paillard € 3/pcs
- Kofta with Thai chilli sauce € 3/pcs
- Kofta with tomato-coriander sauce € 3/pcs
- Grilled seasonal vegetables with Provencal seasoning and butter € 3/pcs

Mini desserts

- Chocolate bar
- Coconut and chocolate cake
- Punch cake
- Nut roll
- Chocolate roll
- Fruit cake
- Caramel cake
- Coconut dessert
- Poppy cake



€ 3
per 1 pcs

CONDITIONS

- VAT is included in the price (VAT is subject to change)
- A service fee of 5% of the total amount will be credited to your account
- Gluten free, vegan and lactose free options available

PANORAMA HOTEL

PRAGUE

BEVERAGE PACKAGES

Beverage package 1 drink

- 1 soft drink or 1 beer 0.33 l or 1 glass of wine 0.15 l



€ 6
per person

Beverage package 2 drinks

- Soft drinks or beer 0.33 l or glass of wine 0.15 l



€ 9
per person

Welcome drink package

- 0.15 l of prosecco



€ 5
per person

Non-alcohol package

- 1 mineral water or soft drink, tea/coffee



€ 3
per person

Unlimited beverage package 1 hour

- Soft drinks, beer, wine, coffee, tea, crisps, nuts



€ 15
per person

Upgrade your beverage package
with a selection of spirits: vodka, gin,
whiskey, rum, Martini € 10 per person

Unlimited beverage package 2 hours

- Soft drinks, beer, wine, coffee, tea, crisps, nuts



€ 25
per person

Every additional hour € 10 per person

Upgrade your beverage package
with a selection of spirits: vodka, gin,
whiskey, rum, Martini € 15 per person

Cocktails 1 hour

- Unlimited basic cocktails such as Mojito, Caipirinha, Cuba Libre, Daiquiri, Cosmopolitan and soft drinks, beer and wine, crisps, nuts



€ 25
per person

CONDITIONS

- VAT is included in the price (VAT is subject to change)
- A service fee of 5% of the total amount will be credited to your account

PANORAMA HOTEL

PRAGUE

OTHER

Corkage fee

- Sparkling / wine bottle € 17
- Beer bottle € 3
- Soft drinks bottle € 2
- Spirits litre € 50
- Beer 50 l keg € 300

Conference equipment

- Speaker's lectern € 21/pcs & day
- Podium 5 × 3 m, height 30 cm € 41/pcs & day
- Dance floor 5 × 5 m € 82/pcs & day
- Data projector € 60/pcs & day
- Screen € 17/pcs & day
- Laser pointer € 15/pcs & day
- Flip chart € 20/pcs & day
- Sound system € 55/pcs & day
- Microphone € 21/pcs & day

In case of using own AV equipment extra 10% of room rental will be added.



CONDITIONS

- VAT is included in the price (VAT is subject to change)
- A service fee of 5% of the total amount will be credited to your account